

REMARKS  
Copyright reserved in favour of the undermentioned architects  
All dimensions are to be checked on site. Only figured dimensions  
are to be used.  
Any references to specialist work, items, finishes etc. are normally  
covered under preliminary amounts or PC items, it not the  
contractor must still price these specialized work, items or finishes.  
Any contradictions must be settled beforehand with architect.  
This drawing to be read in conjunction with Structural, Civil,  
Electrical and Mechanical Engineers drawings.  
All materials to be paint finished as specified where supplied  
without factory finish.  
Building work to comply with SANS 10400 National Building  
regulations  
Glass installation to comply with SANS 10137, National Building  
regulations and SAGI (South African Glass Institute)  
55-kg g5-as in doors must be m5-fixed with visible b5-nd.

75-BEL - DIMENSIONS OF GL5-SS  

Nominal thickness of g5-ss, mm	M5-maximum size of g5-ss, meter
3	0,75
4	1,5
5	2,1
6	3,2

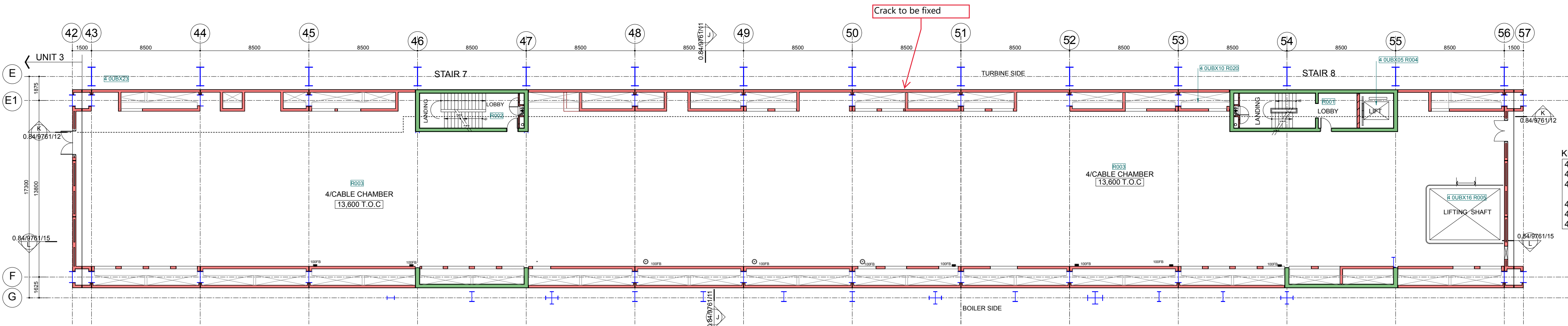

- KKS CODES- Level 13.600 4 OUBX23
- 4 OUBX05 R004 - Unit 4 Auxiliary Bay Lift Shaft
  - 4 OUBX10 R020 - Unit 4 Auxiliary Bay HVAC Shaft
  - 4 OUBX16 R005 - Unit 4 Auxiliary Bay Equipment Lift Shaft
  - 4 OUBX23 R001 - Unit 4 Auxiliary Bay Level 13.600 Lift Lobby and Stairwell Room 1
  - 4 OUBX23 R002 - Unit 4 Auxiliary Bay Level 13.600 Stairwell Room 2
  - 4 OUBX23 R003 - Unit 4 Auxiliary Bay Level 13.600 Cable Chamber

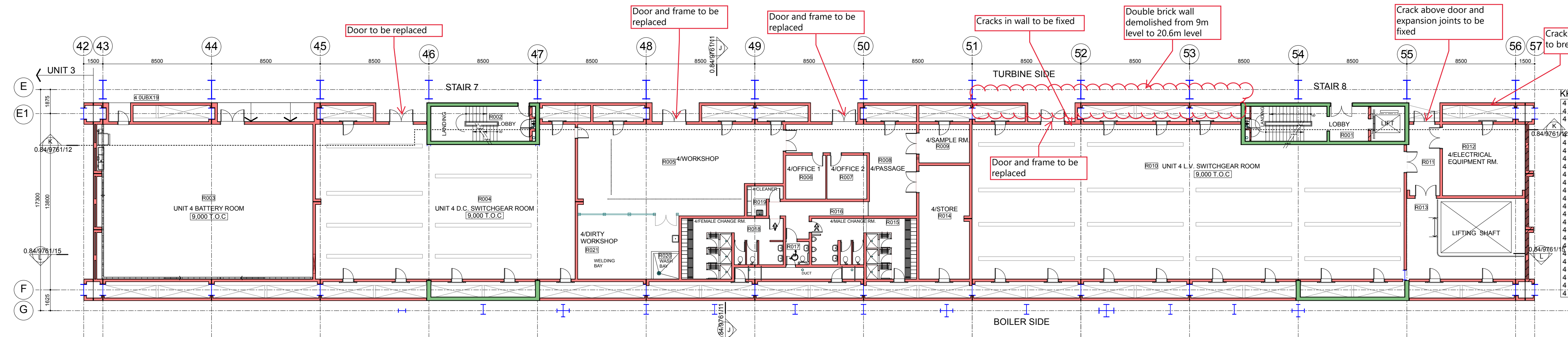

- KKS CODES- Level 9.000 4 OUBX19
- 4 OUBX05 R004 - Unit 4 Auxiliary Bay Lift Shaft
  - 4 OUBX10 R020 - Unit 4 Auxiliary Bay HVAC Shaft
  - 4 OUBX16 R005 - Unit 4 Auxiliary Bay Equipment Lift Shaft
  - 4 OUBX19 R001 - Unit 4 Auxiliary Bay Level 9.000 Lift Lobby and Stairwell Room 1
  - 4 OUBX19 R002 - Unit 4 Auxiliary Bay Level 9.000 Stairwell Room 2
  - 4 OUBX19 R003 - Unit 4 Auxiliary Bay Level 9.000 Unit Battery Room
  - 4 OUBX19 R004 - Unit 4 Auxiliary Bay Level 9.000 Unit D.C. Switchgear Room
  - 4 OUBX19 R005 - Unit 4 Auxiliary Bay Level 9.000 Workshop
  - 4 OUBX19 R006 - Unit 4 Auxiliary Bay Level 9.000 Office 1
  - 4 OUBX19 R007 - Unit 4 Auxiliary Bay Level 9.000 Office 2
  - 4 OUBX19 R008 - Unit 4 Auxiliary Bay Level 9.000 Passage 1
  - 4 OUBX19 R009 - Unit 4 Auxiliary Bay Level 9.000 Sample Room
  - 4 OUBX19 R010 - Unit 4 Auxiliary Bay Level 9.000 Unit L.V. Switchgear Room
  - 4 OUBX19 R011 - Unit 4 Auxiliary Bay Level 9.000 Passage 2
  - 4 OUBX19 R012 - Unit 4 Auxiliary Bay Level 9.000 Electrical Equipment Room
  - 4 OUBX19 R013 - Unit 4 Auxiliary Bay Level 9.000 Equipment Lift Shaft Access Room
  - 4 OUBX19 R014 - Unit 4 Auxiliary Bay Level 9.000 Store
  - 4 OUBX19 R015 - Unit 4 Auxiliary Bay Level 9.000 Male Change Room
  - 4 OUBX19 R016 - Unit 4 Auxiliary Bay Level 9.000 Passage 3
  - 4 OUBX19 R017 - Unit 4 Auxiliary Bay Level 9.000 Disabled Toilet
  - 4 OUBX19 R018 - Unit 4 Auxiliary Bay Level 9.000 Female Change Room
  - 4 OUBX19 R019 - Unit 4 Auxiliary Bay Level 9.000 Cleaner Room
  - 4 OUBX19 R020 - Unit 4 Auxiliary Bay Level 9.000 Dirty Workshop Wash Bay
  - 4 OUBX19 R021 - Unit 4 Auxiliary Bay Level 9.000 Dirty Workshop

NOTE:  
This is a reference drawing only  
For 1:100 Working drawing see  
sheets 7 & 8

For KKS room Codes  
see plan layouts

KKS Structure  
CODE: 4 OUBX

ISSUED FOR CONSTRUCTION

D.O.	REV	DATE	INDEX REFERENCE	REV BY	CHKD BY	AUTH BY	KKS APP	REFERENCE DRAWINGS
9		2017.03.17	AS BUILT	gb	I dl R	wms		
8		2013.04.15	KKS Level & Room Codes added	gb	I dl R	wms		
7		2012.11.14	general updates see 1:100 layout	gb	I dl R	wms		
6		2012.06.07	KKS CODE added, general updates see 1:100 layout	gb	I dl R	wms		
5		2012.01.05	general updates see 1:100 layout	gb	I dl R	wms		
4		2010.07.27	general updates see 1:100 layout	gb	I dl R	wms		
3		2010.05.21	General updates see 1:100 layout	gb	I dl R	wms		
2		2010.04.28	HOLD cancelled End walls revised, internal walls c-joints & brick piers added	gb	I dl R	wms		
1		2010.03.01	ISSUED FOR CONSTRUCTION	gb	I dl R	wms		0.84/9761/8 Plan Level 13.600
0		09/11/06	ISSUED FOR REVIEW	gb	I dl R	wms		0.84/9761/7 Plan Level 9.000
** REVISION **								

DRG REGISTR	APPROVED	DO AUTH	CHKD BY	DRAWN BY	SCALE
09/11/04	I dl R	09/11/04	I dl R	09/11/04	1:200

AUTHORISED FOR ESKOM BY	DATE
C.Pretorius	2010.02.25

**MEDUPI POWER STATION**  
**AUX BAY**  
**UNIT 4 LEVEL**  
**9.000 & 13.600 FULL VIEW**

07015 - A4 - 23.002

0.84/9761

29

SHEET

REV

SIZE

GROUPE

A1L